

| No.  | TENANT                          | ADDRESS              | NO. DEERFIELD BLVD. | STE | NO. | SO. FT. |
|------|---------------------------------|----------------------|---------------------|-----|-----|---------|
| 1101 | RELIISH MODERN TAPAS RESTAURANT | 5947 DEERFIELD BLVD. | 100                 |     |     | 3,682   |
| 1104 | COLDWELL BANKER                 | 5947 " "             |                     |     |     | 4,634   |
| 1201 | ALLEN & ASSOCIATES, LPA         | 5947 " "             | 201                 |     |     | 2,233   |
| 1202 |                                 | 5947 " "             |                     |     |     | 1,419   |
| 1203 | ILLUMINATION RESEARCH           | 5947 " "             |                     |     |     | 3,897   |
| 1204 |                                 | 5947 " "             |                     |     |     | -       |
| 2101 | LIBERTY MUTUAL INSURANCE        | 5939 " "             | 101                 |     |     | 2,200   |
| 2102 |                                 | 5939 " "             | 102                 |     |     | 1,608   |
| 2103 | PURE BARRE MASON                | 5939 " "             | 105                 |     |     | 1,251   |
| 2104 | SKIDDADLES                      | 5939 " "             | 104                 |     |     | 4,002   |
| 2201 | ROCKET SCIENCE                  | 5939 " "             | 201                 |     |     | 7,900   |
| 800  | MATSON MONEY                    | 5955 " "             |                     |     |     | 39,100  |

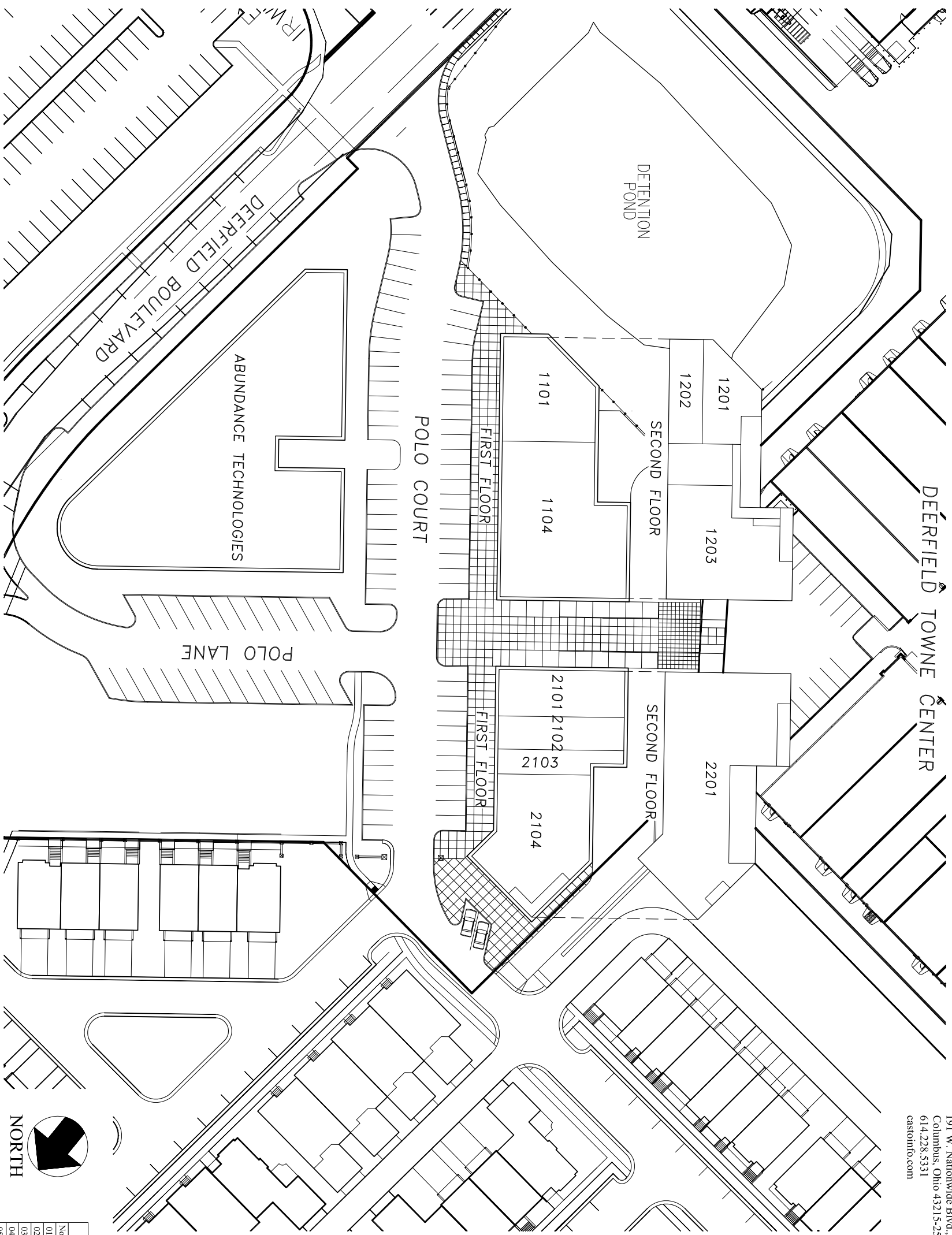

191 W. Nationwide Blvd., Suite 200  
 Columbus, Ohio 43215-2568  
 614.228.5331  
 castoimfo.com



| REVISIONS |         |
|-----------|---------|
| No.       | DATE    |
| 01        | 9-18-08 |
| 02        | 3-17-09 |
| 03        | 11-5-09 |
| 04        | 4-7-10  |
| 05        | 11-2-11 |
| 06        | 1-17-12 |

\* BUILDING SIZES AND CONFIGURATIONS MAY CHANGE

VILLAGE SQUARE