

No.	TENANT	ADDRESS	SO. FT.
300	KOHL'S	HANES MALL BLVD	86,584
320	MICHAEL'S	"	40,120
1000	BED BATH & BEYOND	"	37,132
1010	PER ONE	"	9,176
1020	FACTORY CARD OUTLET	"	11,952
1030	GAMESTOP	"	1,920
1040	DOLLAR TREE	"	9,200
1050	CATHERINES	"	5,000
1060	SALLY BEAUTY	"	1,400
1070	MARIO'S PIZZA	"	1,400
1080	KIMONO JAPANESE EXPRESS	"	1,400
1090	SHOE CARNIVAL	"	12,000
1100	RUE21	"	6,000
1110	LIFEWAY CHRISTIAN RESOURCES	"	6,000
1120	ANGEL NAIL	"	4,900
1130	CARTRIDGE WORLD	"	1,050
1140	GREAT CLIPS	"	1,400
1150	TARGET	"	1,200
ES&M	TARGET	"	"

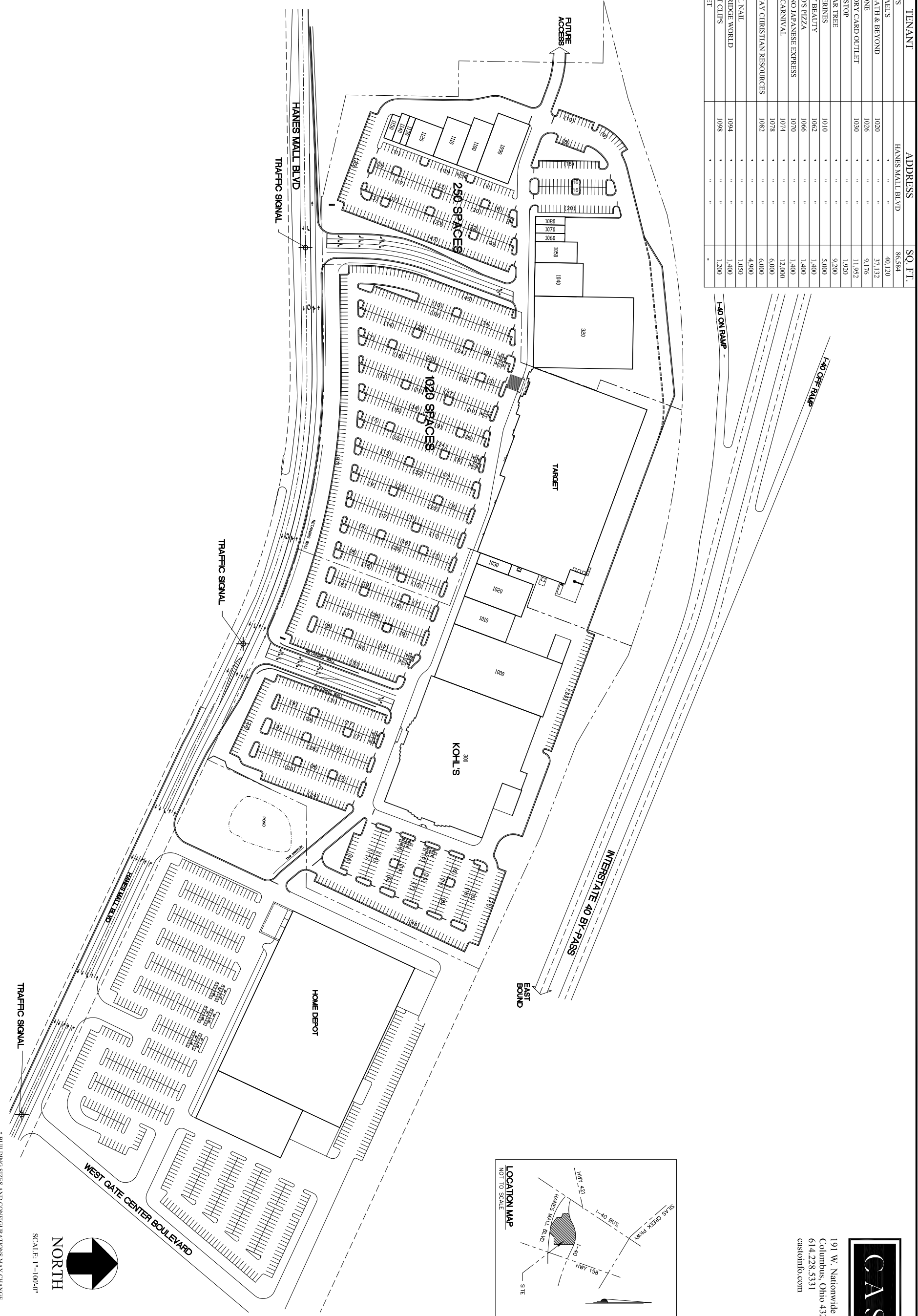

191 W. Nationwide Blvd., Suite 200
 Columbus, Ohio 43215-2568
 614.228.5331
 castoimfo.com

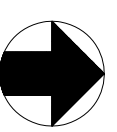
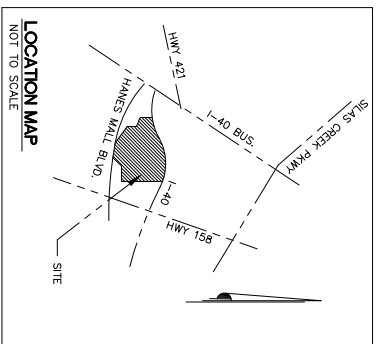

SCALE: 1"=100'-0"

No.	DATE	REVISIONS
04	2-28-07	
05	7-22-08	
06	9-25-08	
07	1-6-09	
08	7-13-09	
09	6-10-10	
10	12-6-10	
11	12-22-10	

HANES POINT

* BUILDING SIZES AND CONFIGURATIONS MAY CHANGE